

HITROL CO., LTD.

HEAD OFFICE.FACTORY.R&D INSTITUTE
HITROL CO.,LTD 141, Palhakgol-road, Jori-eup
Paju-si, Gyeonggi-do, Korea
TEL. : (00)-82-31-950-9700
FAX. : (00)-82-31-943-5600
www.hitrol.com



CATALOGUE

Level Switch for Magnet Float Type Level Gauge HR-10L Series

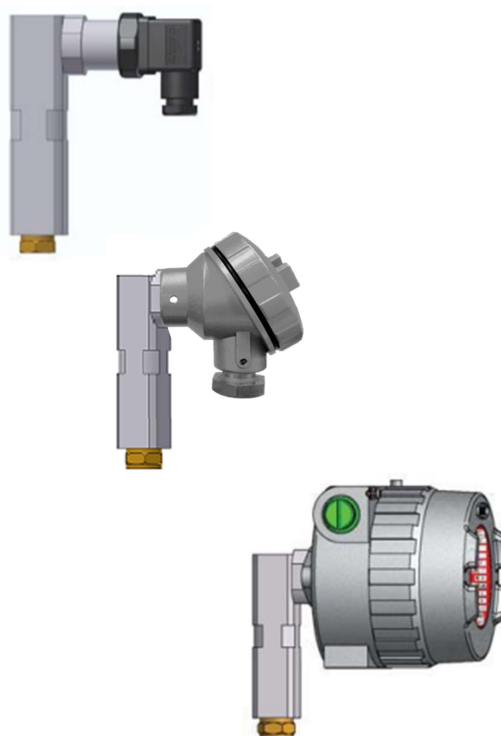

Doc. no. : HR-10L_E_Rev.0

Issue date : 2024. 10

Overview and Feature

The HR-10L (Ex) Series attaches to its Level Gauge (HLG-100F) to detect the liquid level inside the various containers (tank). It is used for processes that perform the function of alarms and controls in water supply or drainage.

Operating and Composition

The Float rises or falls when the liquid level inside the Level Gauge rises or falls. If a magnet in the Float passes the contact point of the Reed Switch inserted into the Chamber within the Level Gauge, the contact point becomes On/Off.

Using this principle, the wiring with the Control Unit can be used to prevent idle of the automatic supply pump of liquid, to alarm the upper and lower level of the liquid, to supply the liquid automatically, and to drain the liquid automatically.

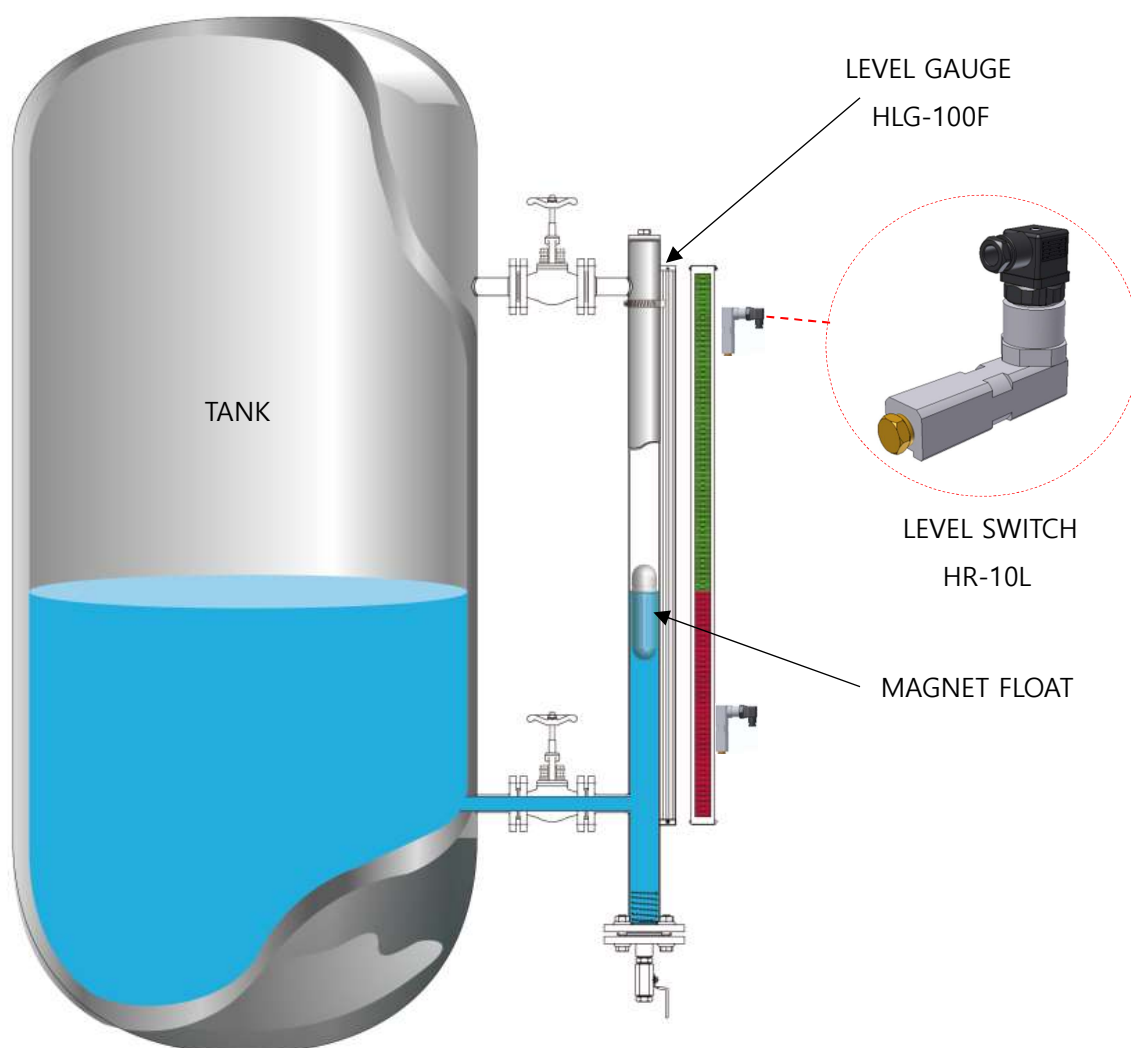

Specification Weather-Proof

Model		HR-10L	
Type		Level Switch	
Mounting		With HLG-100F Band Fasten	
Ambient Temperature		-20°C ~ +60°C	
Enclosure		Weather-Proof (IP65)	
Material	Head	PA66	ALC
	Body	Duralumin	
Switch Type		Reed Switch	
Max. Switching Voltage		24 VDC	
Switch Form		SPDT	
Cable Entry		PG 7	PF 1/2"(F)

Ex-Proof

Model		HR-10L-Ex	
Type		Level Switch	
Mounting		With HLG-100F Band Fasten	
Ambient Temperature		-20°C ~ +60°C	
Enclosure		Ex-Proof (Ex d IIC T6,IP65)	
Material	Head	ALC	
	Body	Duralumin	
Switch Type		Reed Switch	
Max. Switching Voltage		24 VDC	
Switch Form		SPDT	
Cable Entry		PF 3/4" (F)	

Contact Rating

Max. Switching voltage	Max. Switching current	Contact rating Capacity(VA)
220VAC/24VDC	0.5A / 0.5A	40W / 10W

Dimension <Weather-Proof>

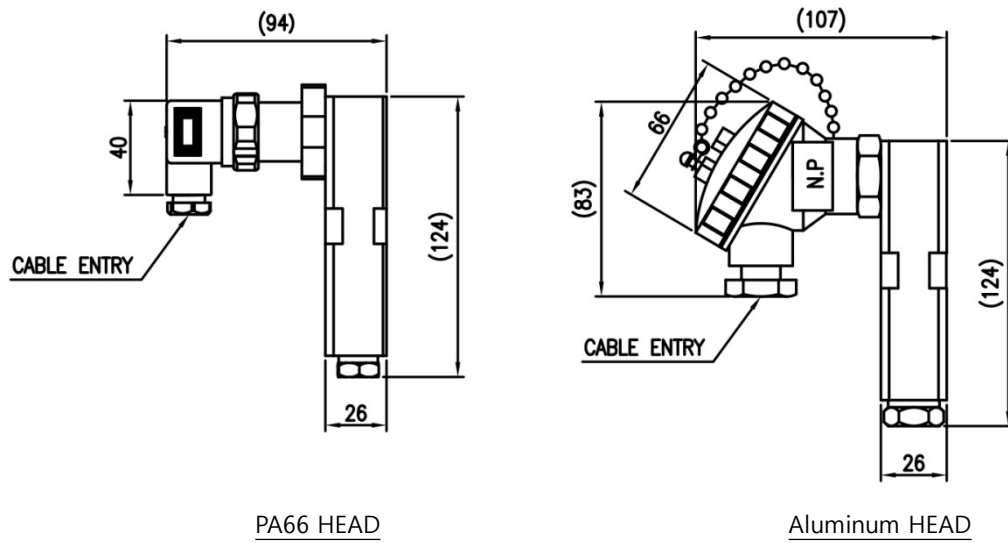

<Ex-Proof>

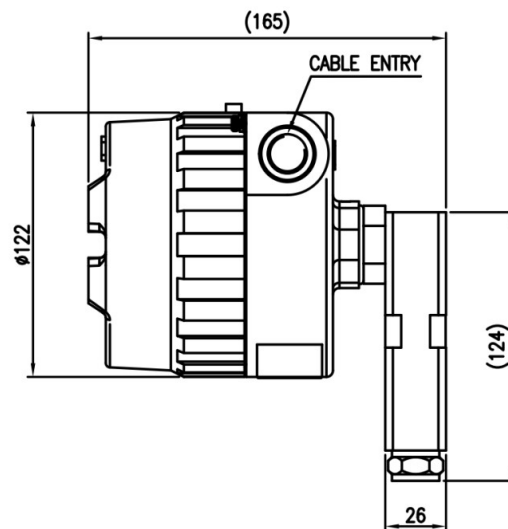

**Precaution
for
Installation**

- As it is assembled and shipped to a level gauge (HLG-100F), no special precautions are required for installation.
- Do not shock the product when transporting or dismantling it.

Headquarter · Factory · R&D Contact Number

Address : 141, Palhagol-gil-road, Jori-eup, Paju-si, Gyeonggi-do, Korea
 Tel. : 031-950-9700
 Fax. : 031-943-5600
 Website : <http://www.hitrol.com>